

4

3

2

1

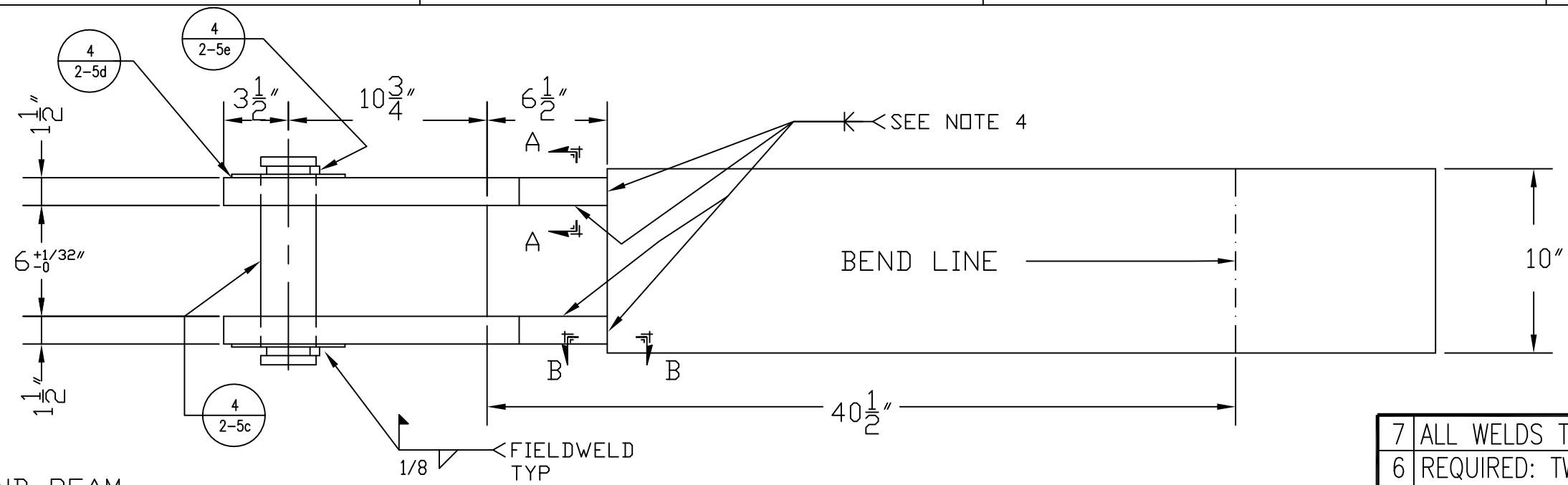

CERTIFIED FOR CONSTRUCTION
12 MAR 99

7	ALL WELDS TO CONFORM TO THE LATEST REV OF AWS D1.1
6	REQUIRED: TWELVE [12] ASSEMBLIES
5	MATERIAL: PLATE, H.R.S. ASTM A36: PIN, C1040 SEMI-AUTOMATIC OR FULLY AUTOMATIC WELD MAY BE USED. NO SCARFING NECESSARY IF THIS METHOD IS USED.

DRILL AND REAM
 $3.000^{+0.002}_{-0.000}''$

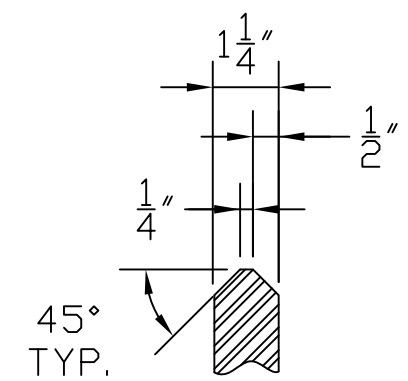
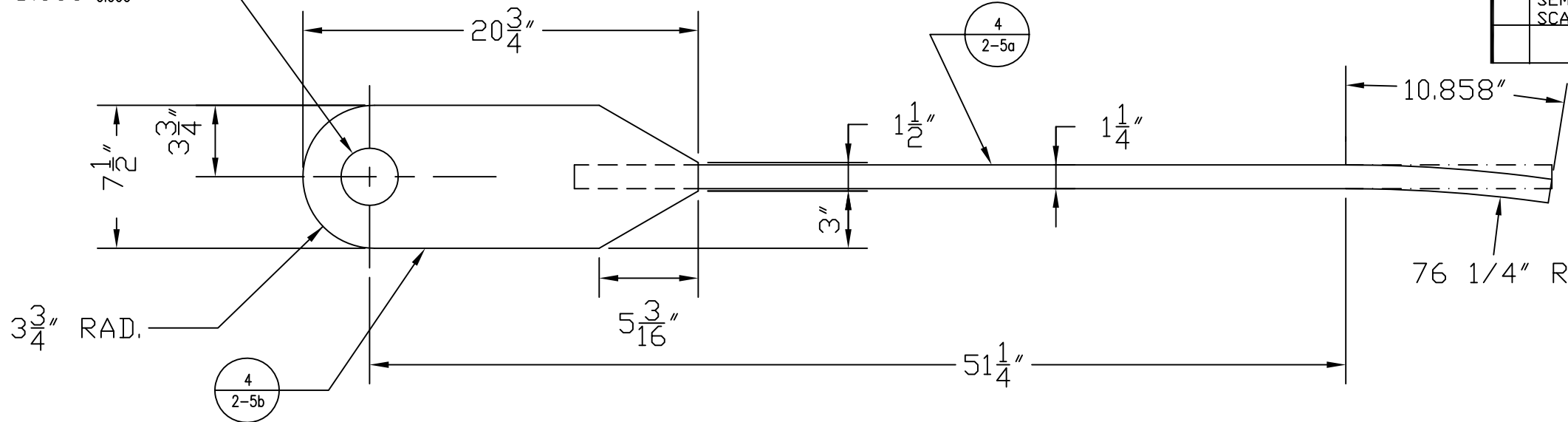

SECTION A-A & B-B
TYPICAL SCARFING
SCALE 2=1

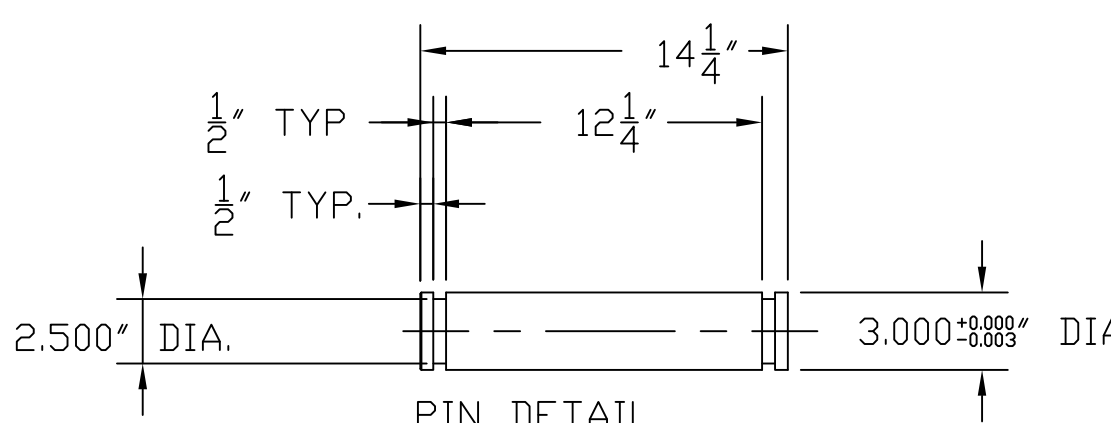

PIN DETAIL

REV. NO	DATE	BY	APPV.	DESCRIPTION

TOLERANCES UNLESS OTHERWISE NOTED

WHOLE NUMBER DIM.	1/16"	ANGULAR DIM.	1/2-
FRACTIONAL DIM.	1/16"	DECIMAL DIM. (.XX)	.010
		DECIMAL DIM. (.XXX)	.005

NOTICE: THE INFORMATION CONTAINED HEREIN IS PROPRIETARY TO LOUISVILLE DRYING MACHINERY AND SHALL NOT BE REPRODUCED OR DISCLOSED IN WHOLE OR IN PART, NOR USED FOR ANY DESIGN OR MANUFACTURING PURPOSE UNLESS AUTHORIZED IN WRITING BY LOUISVILLE DRYING MACHINERY



CUSTOMER:
DESCRIPTION: GEAR LEAF SPRING



DWG. BY: RPS DATE: 12-20-2009
CHK. BY: -
APPROVED BY: -
SCALE: DWG.# LEAF SPRING
SHT. # OF:

4

3

2

1